

## 9mm AMBI Lower With Last Round Bolt Hold Open Assembly Instructions

### Included parts

Part Name	Quantity	Part Name	Quantity
Ejector	1	Proprietary bolt catch spring	1
Extended tip set screw	2	Magazine release	1
LRBHO Lever	1	Threaded pivot pin	4
Spacer pin	1	Rear takedown spring/detent retention set screw	1
AMBI bolt release switch	1	Upper tensioning set screw	1

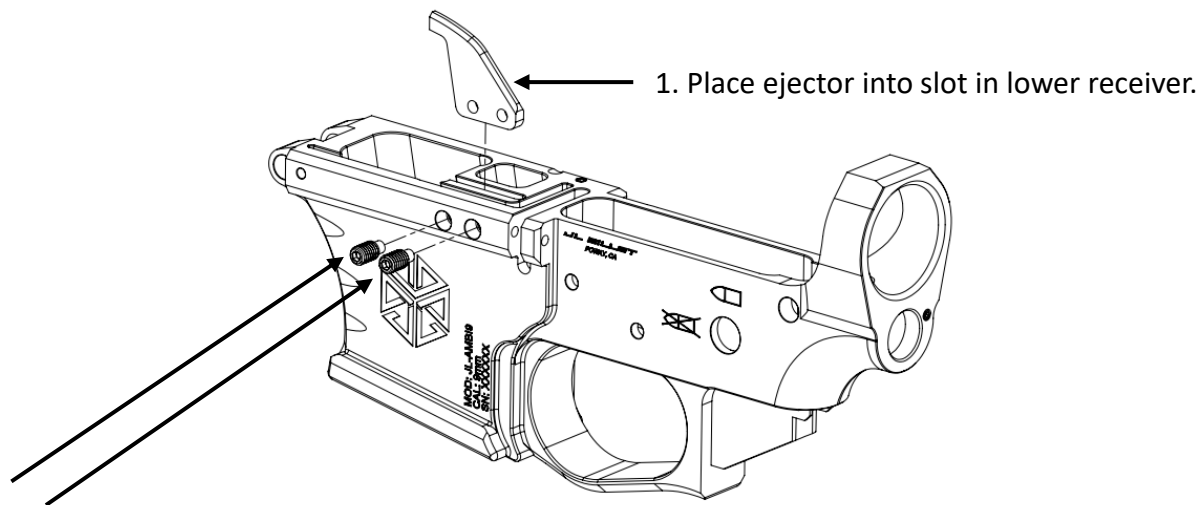

2. Using a 3/32" Allen drive, install extended-tip set screws. Ensure set screw tips seat into the holes in the ejector. Torque screws to 15 in-lbs. Use of blue Loctite is recommended.

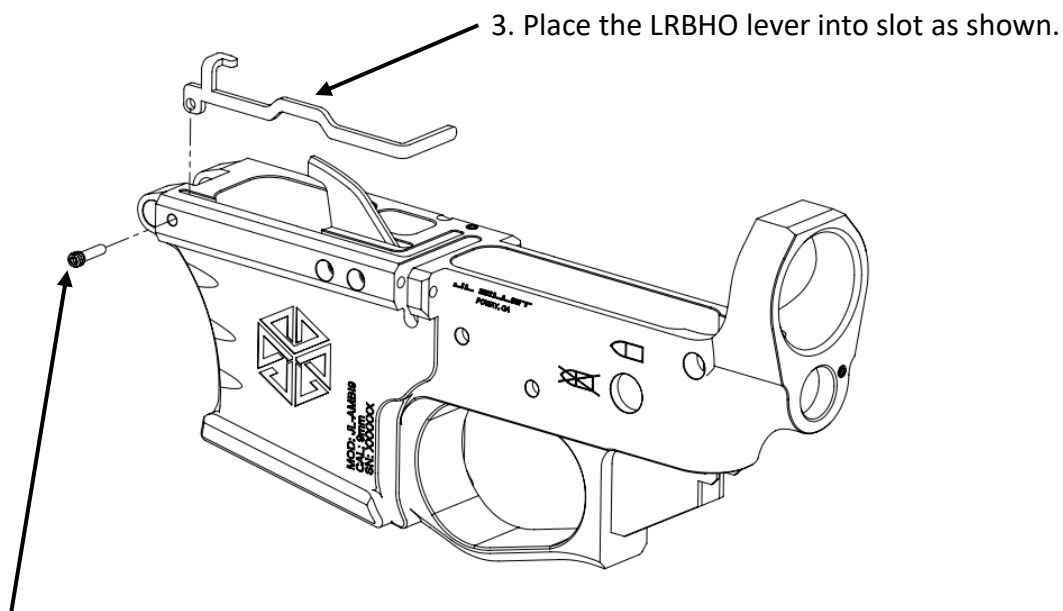

5. Install AMBI bolt release switch and secure with threaded pivot pin

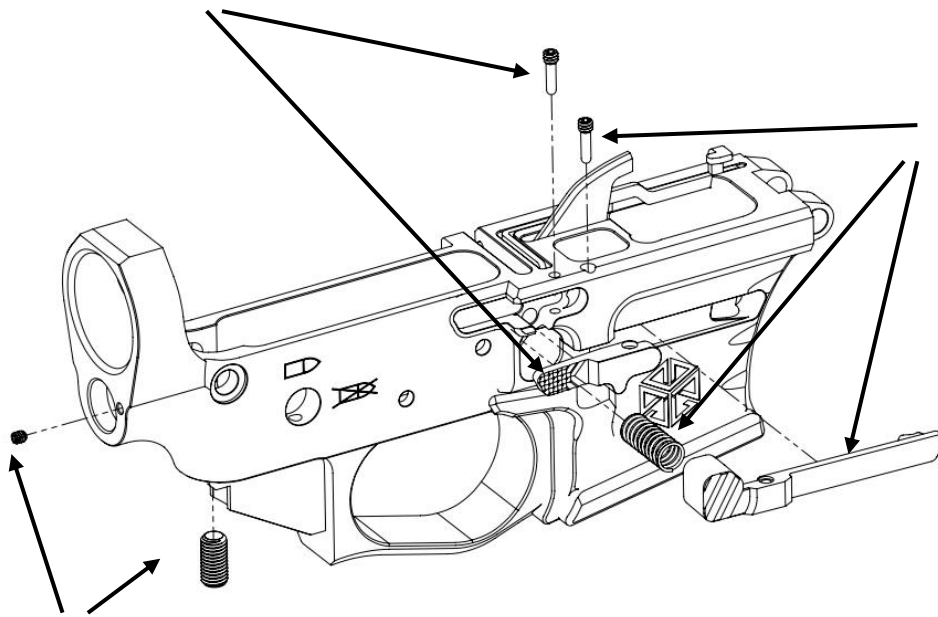

6. Install standard AR-15 magazine release spring and magazine release then secure with threaded pivot pin. (Standard mag-release spring not included.)

( Rear takedown spring/detent retention set screw, and upper tensioning set screw assembly locations shown for reference )

7. Install spacer pin, proprietary bolt catch spring and plunger into the lower receiver as shown then secure bolt catch with threaded pivot pin. Ensure that the plunger and spring move freely in the hole prior to installing bolt catch. (Standard bolt catch and plunger not included)

